

SYSTEM COMPONENTS

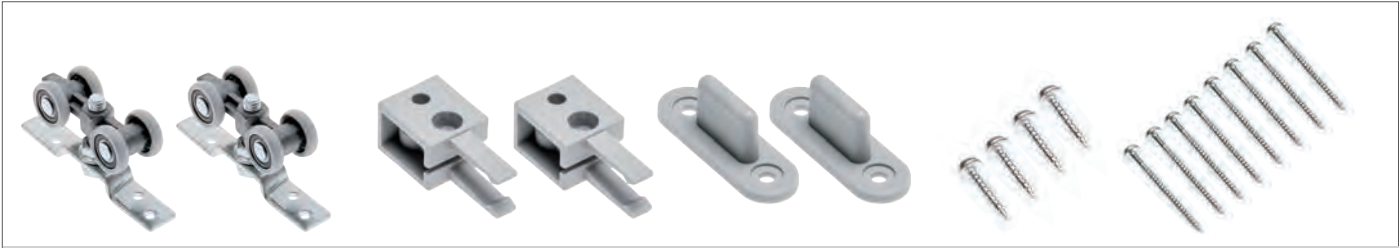
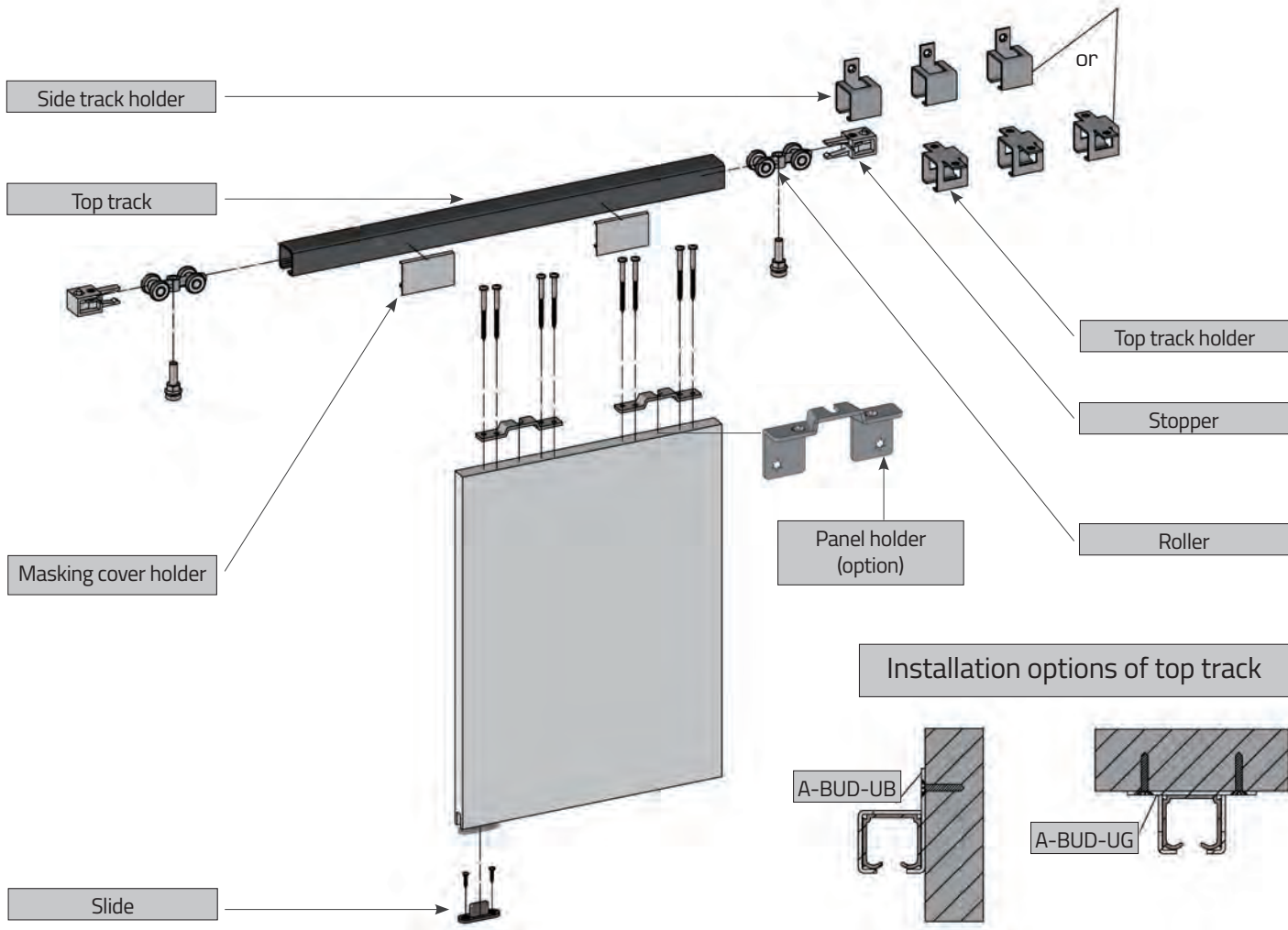

A-BUDP-SET
 QUANTUM set: 2 rollers , 2 stoppers, 2 slides, set of screws

Top track	A-BUD-UB Side holder	A-BUD-UG Top holder	A-BUD-UM masking cover holder of top track	A-BUD-UP Panel holder

Length	Index
200 cm	A-TG-BUD-200-00
300 cm	A-TG-BUD-300-00
400 cm	A-TG-BUD-400-00
600 cm	A-TG-BUD-600-00

Ball bearing
 50 kg
 Panel 16-28 mm

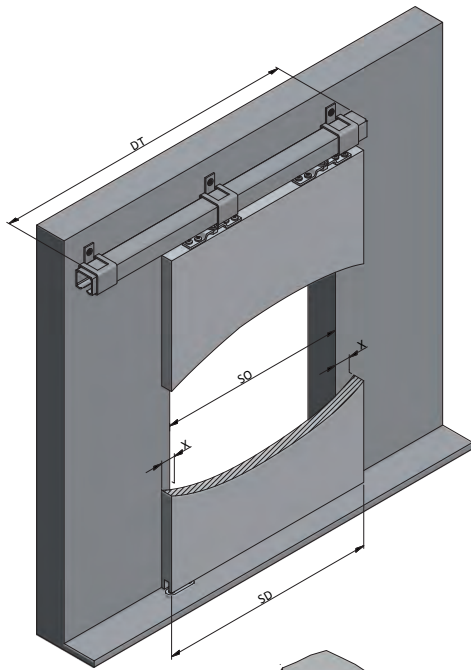

To hide the slide behind the wall min.
X = 46 mm

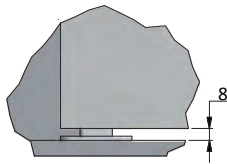

SO - space width
 X - overlap width
 SD - door width (including overlaps)

OPTION 1

(doors touching the perpendicular wall)

$$SD = SO + X$$

DT - track length

$$DT = 2 * SO$$

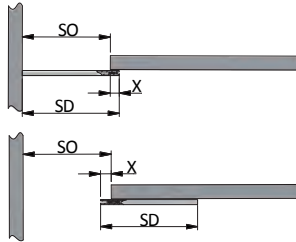

OPTION 2

(doors parallel to the wall)

$$SD = SO + 2 * X$$

DT - track length

$$DT = SD + SO$$

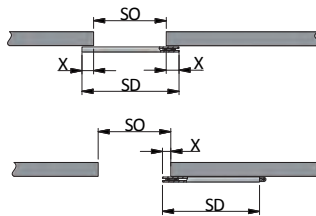

MOUNTING DIMENSIONS

Door guidance for system suspended from the ceiling

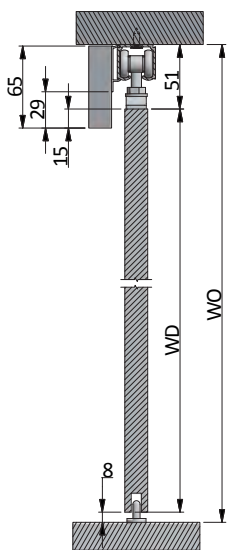

Door height for track mounted to the ceiling
 $WD = WO - 59$

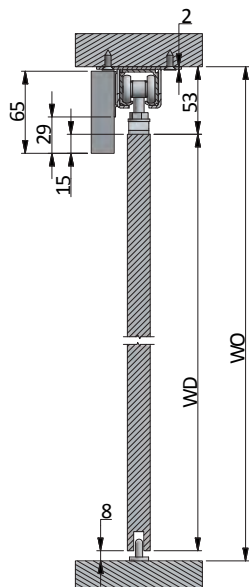

Door height for track mounted in the top track holder
 $WD = WO - 61$

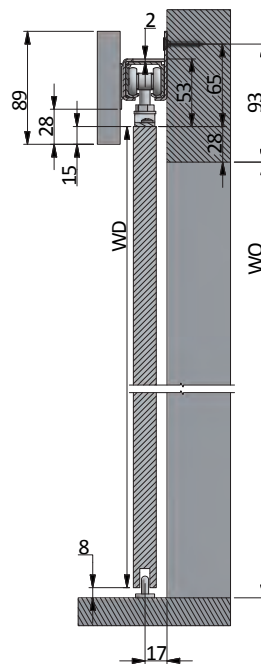

Door height for track mounted in the side track holder
 $WD = WO + 20$

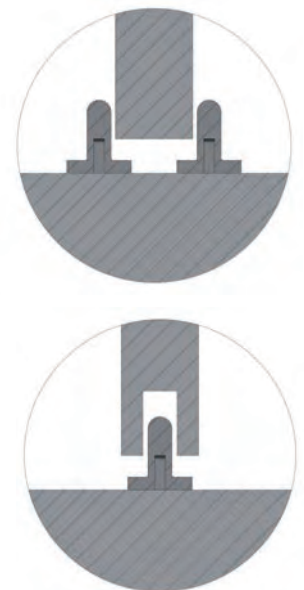

WD = door height
 WO = space width

INSTALLATION OF SYSTEM

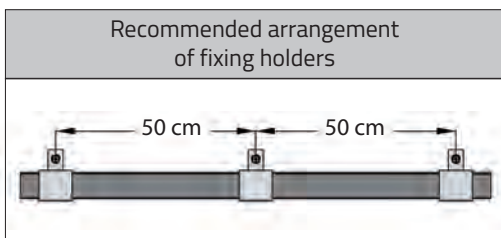
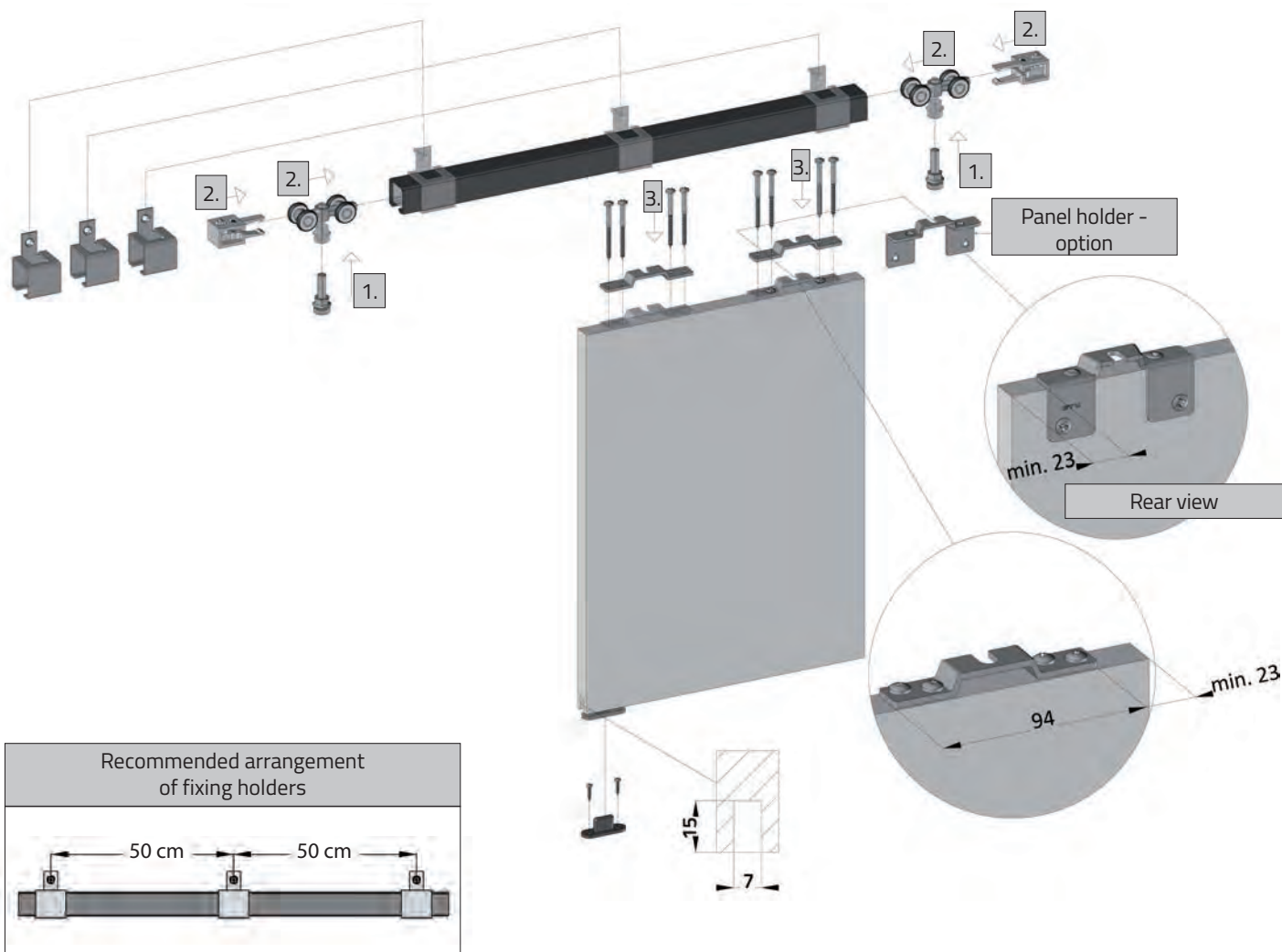

STOPPER POSITION SETTING

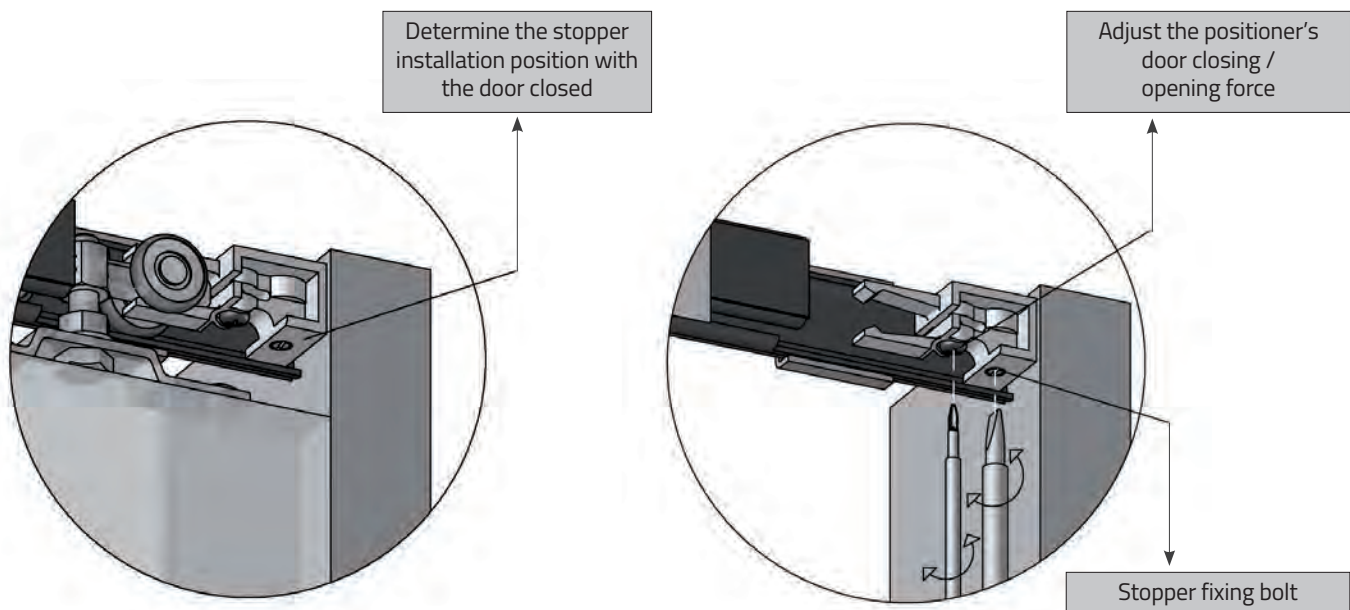

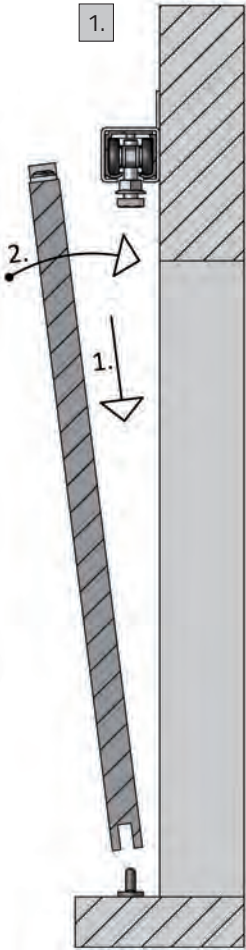

1. Set the door.

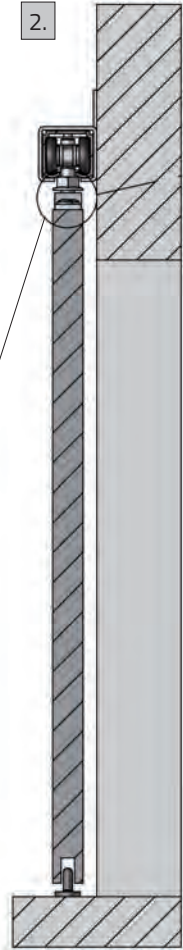

2. Insert the door in the top roller.

Leave clearance for the lock nut on the roller bolt.

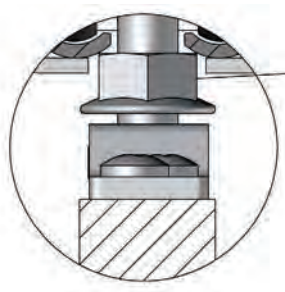

Mount and adjust the doors.

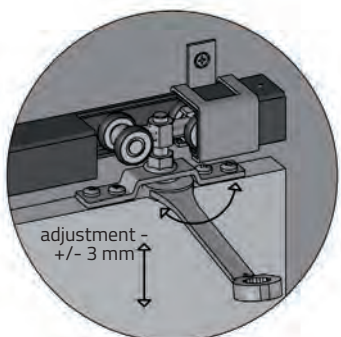

Secure the doors with the lock nut.

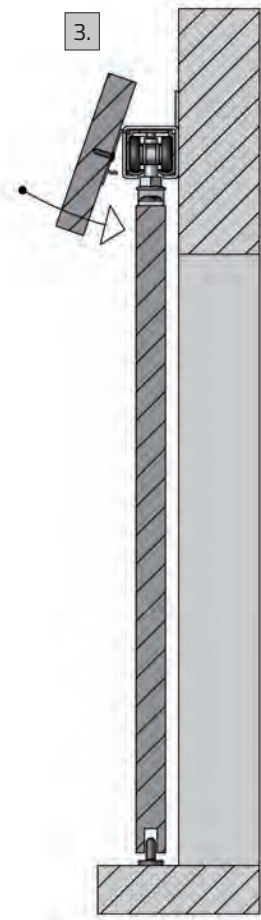
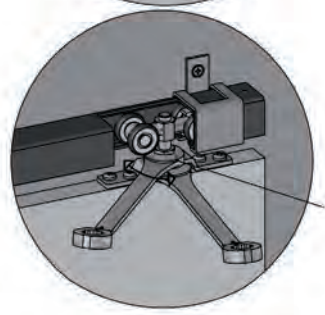

3. Attach the masking cover to the track.